

The L-Lock System was designed to be fully compatible with the Lehnhoff standard. For maximum reliability, all contact surfaces of the L-Lock quick couplers are mechanically machined and therefore lock safely and without unwanted play or movement. The hydraulic versions are equipped with drop stop claws for additional safety.

- ▷ KMS-L with mechanical & KHS-L with hydraulic locking system.
- ▷ Safe mechanic or hydraulic locking available.
- ▷ Use of robust and durable cast housings.
- ▷ All hydraulic quick couplers system L-Lock are equipped with drop stop claws as standard! The Kinshofer quick coupler systems thus fully comply with all applicable national and international standards and regulations, including Machinery Directive 2006/42/EG, DIN EN 474-1, ISO13031 and SUVA.



here with hook and drop stop claws

The hydraulic KHS+ quick couplers are characterized by a very high safety standard. The drop stop (extended quick coupler claw) prevents the attachment from falling down if the quick coupler lock is accidentally not locked properly. To further increase safety, the KHS+ quick coupler has also been equipped with the new safe lock indicator that reliably indicates proper locking. The KHS+ couplers fully comply with all applicable national and international standards and regulations, including Machinery Directive 2006/42/EG, DIN EN 474-1, ISO13031 and SUVA.

Mechanic Quick Couplers KMS-L

Type	Locking	Weight (kg/lbs)	Suitable adapter	Operating weight (t/lbs)
KMS01L	mechanic	15 / 33	KSW01	0.5 - 2.0 / 1,100 - 4,400
KMS03L	mechanic	30 / 66	KSW03	1.5 - 6.5 / 3,300 - 14,300
KMS08L	mechanic	75 / 165	KSW08	6.0 - 12.0 / 13,200 - 26,400

Package consists of: mechanic quick coupler, socket

Hydraulic Quick Couplers KHS-L (including drop stop)

Type	Locking	Weight (kg/lbs)	Suitable adapter	Operating weight (t/lbs)
KHS01L	hydraulic	15 / 33	KSW01	0.5 - 2.0 / 1,100 - 4,400
KHS03L	hydraulic	30 / 66	KSW03	1.5 - 5.5 / 3,300 - 12,100
KHS03L HD	hydraulic	31 / 68	KSW03	4.8 - 7.0 / 10,560 - 15,400
KHS08L	hydraulic	80 / 176	KSW08	6.0 - 12.0 / 13,200 - 26,400

Package consists of: hydraulic quick coupler with drop stop claws

Hydraulic Quick Couplers KHS-L+ (including drop stop & safe lock indicator)

Type	Locking	Weight (kg/lbs)	Suitable adapter	Operating weight (t/lbs)
KHS01L+	hydraulic	16 / 35	KSW01	0.5 - 2.0 / 1,100 - 4,400
KHS03L+	hydraulic	31 / 68	KSW03	1.5 - 5.5 / 3,300 - 12,100
KHS03L HD+	hydraulic	32 / 70	KSW03	4.8 - 7.0 / 10,560 - 15,400
KHS08L+	hydraulic	82 / 180	KSW08	6.0 - 12.0 / 13,200 - 26,400

Package consists of: hydraulic quick coupler with drop stop claws and lock indicator



Safely locked. Indicator pin is driven in.



Unlocked for the coupling process. Indicator pin is extended.



Not correctly locked. Locking pins are above the permitted range. Indicator pin is extended.

Requirements of carrier machine for KHS-L / KHS-L HD

	KHS01L & KHS03L	KHS03L HD & KHS08L
Hydraulic system:	KHS: one single-acting hydraulic circuit / KHS HD: one double-acting hydraulic circuit	
Note:	excavator needs to be equipped with quick coupler control	

The L-Lock System was designed to be fully compatible with the known and in nationally adopted Lehnhoff adapters. For maximum reliability, all contact surfaces of the L-Lock quick couplers are machined and therefore lock safely and without unwanted play or movement. The hydraulic versions are equipped with drop stop claws for additional safety.

here with load hook and drop stop claws

- ▷ KMS-L with mechanic locking system.
- ▷ KHS-L with hydraulic locking system.
- ▷ Safe mechanic or hydraulic locking available.
- ▷ Use of robust and durable cast housings.
- ▷ Fully compatible with the original quick coupler systems or standards.
- ▷ All hydraulic quick couplers system L-Lock are equipped with drop stop claws as standard! The Kinshofer quick coupler systems thus fully comply with all applicable national and international standards and regulations, including Machinery Directive 2006/42/EG, DIN EN 474-1, ISO13031 and SUVA.



The hydraulic KHS+ quick couplers are characterized by a very high safety standard. The drop stop (extended quick coupler claw) prevents the attachment from falling down if the quick coupler lock is accidentally not locked properly. To further increase safety, the KHS+ quick coupler has also been equipped with two sensors that reliably indicate proper locking. The KHS+ couplers fully comply with all applicable national and international standards and regulations, including Machinery Directive 2006/42/EG, DIN EN 474-1, ISO13031 and SUVA.

Mechanic Quick Couplers KMS-L

Type	Locking	Weight (kg/lbs)	Operating weight (t/lbs)
KMS10L	mechanic	170 / 374	10 - 19 / 22,000 - 41,800
KMS21L	mechanic	270 / 594	19 - 28 / 41,800 - 61,600
KMS25L	mechanic	360 / 792	26 - 34 / 57,200 - 74,800

Package consists of: mechanic quick coupler, socket

Hydraulic Quick Couplers KHS-L (including drop stop)

Type	Locking	Weight (kg/lbs)	Operating weight (t/lbs)
KHS10L	hydraulic	170 / 374	10 - 19 / 22,000 - 41,800
KHS21L	hydraulic	270 / 594	19 - 28 / 41,800 - 61,600
KHS25L	hydraulic	360 / 792	26 - 34 / 57,200 - 74,800

Package consists of: hydraulic quick coupler with drop stop claws

Hydraulic Quick Couplers KHS-L+ (including drop stop & sensors)

Type	Locking	Weight (kg/lbs)	Suitable adapter	Operating weight (t/lbs)
KHS10L+	hydraulic	174 / 385	KSW10	10 - 19 / 22,000 - 41,800
KHS21L+	hydraulic	279 / 614	KSW21	19 - 28 / 41,800 - 61,600
KHS25L+	hydraulic	369 / 812	KSW25	26 - 34 / 57,200 - 74,800

Package consists of: hydraulic quick coupler with drop stop claws, KHS10-25L installation set sensor, KHS-L-Sensor



KHS21L+ here with hook



Requirements of carrier machine for KHS-L

Operating pressure (to be set at excavator):	210 - 300bar / 3,040 - 4,350psi
Hydraulic system:	one double-acting hydraulic circuit
Note:	excavator needs to be equipped with quick coupler control.

Accessories for Quick Couplers, Tilt Couplers and Rotary Couplers

unlockable flip switch (hold to run)



KHS Control

Installations sets for hydraulic quick couplers and tilt couplers

Type	Description
KHS01L-KHS03L installation set safety	incl. KHS Control unit
KHS01L-KHS03L installation set basic	incl. unlockable flip switch (hold to run)
KHS03L HD-KHS08L installation set safety	incl. KHS Control unit
KHS03L HD-KHS08L installation set basic	incl. unlockable flip switch (hold to run)

Non-return valve sets for hydraulic tilt couplers TC

Type	Description
TC02-TC03-180 NRV	non-return valve set for TC02 and TC03
TC045-180 NRV	non-return valve set for TC045
TC07-180 NRV	non-return valve set for TC07
TC10-180 NRV	non-return valve set for TC10
TC14-140 NRV	non-return valve set for TC14

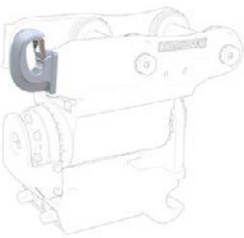

Load hook for quick couplers and tilt couplers

Type	Description
KM 685 06 KSW01 hook	load hook for system L-Lock (1t / 2,200lbs load capacity)
KM 685 06 KSW03 hook 2t	load hook for system L-Lock (2t / 4,400lbs load capacity)
KM 685 06 KSW03 hook 3t	load hook for system L-Lock (3t / 6,600lbs load capacity)
KM 685 06 KSW08 hook	load hook for system L-Lock (5t / 11,000lbs load capacity)

KMS01L socket & KMS03L socket



KMS08L socket

Sockets for mechanic quick couplers and tilt couplers

Type	Description
KMS01L socket	socket for mechanical System L-Lock (KMS01)
KMS03L socket	socket for mechanical System L-Lock (KMS03)
KMS08L socket	socket for mechanical System L-Lock (KMS08) and S-Lock

Quick coupling adapters for System L-Lock

Type	Description
KSW01 rigid	bolt-on adapter
KSW01 cardanic	adapter for cardanic suspension incl. suspension, w/o pendulum damper
KSW03 rigid	bolt-on adapter
KSW03 cardanic	adapter for cardanic suspension incl. suspension, w/o pendulum damper
KSW08 rigid	bolt-on adapter
KSW08 cardanic	adapter for cardanic suspension incl. suspension, w/o pendulum damper



Accessories for Quick Couplers, Tilt Couplers & Rotary Couplers

unlockable flip switch (hold to run)



KHS Control

Installations sets for hydraulic quick couplers and tilt couplers

Type	Description
KHS03L HD-KHS08L installation set safety	incl. KHS Control unit
KHS03L HD-KHS08L installation set basic	incl. unlockable flip switch (hold to run)
KHS10L installation set safety	incl. KHS Control unit
KHS10L installation set basic	incl. unlockable flip switch (hold to run)
KHS21L installation set safety	incl. KHS Control unit
KHS21L installation set basic	incl. unlockable flip switch (hold to run)
KHS25L installation set safety	incl. KHS Control unit
KHS25L installation set basic	incl. unlockable flip switch (hold to run)



Locking sensor for hydraulic quick couplers and tilt couplers with System L-Lock

Type	Description
KHS-L-Sensor	2 sensors support the secure locking, only in combination with KHS10-25L installation set sensor
KHS10-25L installation set sensor	KHS-L installation set safety including cable loom for quick coupler sensors

Non-return valve sets for hydraulic tilt couplers TC



Type	Description
TC14-140 NRV	non-return valve set for TC14-140
TC19-140 NRV	non-return valve set for TC19-140
TC23-140 NRV	non-return valve set for TC23-140

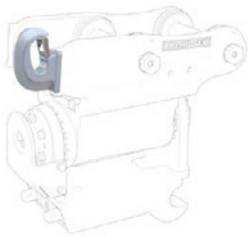

Load hook for quick couplers and tilt couplers

Type	Description
KM 685 06 KSW10 hook	load hook (8t/17,600lbs load capacity)
KM 685 06 KSW21 hook	load hook (10t/22,000lbs load capacity)
KM 685 06 KSW25 hook	load hook (18t/39,600lbs load capacity)



Sockets for mechanic quick couplers and tilt couplers

Type	Description
KMS10L socket	socket for mechanical System L-Lock (KMS10L)
KMS21/25L socket	socket for mechanical System L-Lock (KMS21L/KMS25L)
KMS08L socket	socket for mechanical System S-Lock



Quick coupling adapters for System L-Lock

Type	Description
KSW10 rigid	bolt-on adapter
KSW10 cardanic	adapter for cardanic suspension incl. suspension, w/o pendulum damper
KSW21/25 rigid	bolt-on adapter
KSW21/25 cardanic	adapter for cardanic suspension incl. suspension, w/o pendulum damper