

The S-Lock System was designed to be fully compatible with the internationally adopted S-Standard adapters. In addition to a specially engineered, centrally located locking mechanism, the S-Lock coupler features a second locking mechanism at the front pin, providing a twin lock system for maximum safety.

- ▷ KMS-S with mechanic locking system.
- ▷ KHS-S with hydraulic locking system.
- ▷ Safe mechanic or hydraulic locking available.
- ▷ Use of robust and durable cast housings.
- ▷ Fully compatible with the original quick coupler systems or standards.



KHS45S  
here with hook

## Mechanic Quick Couplers KMS-S

| Type       | Locking  | Weight<br>(kg/lbs) | Operating weight<br>(t/lbs)  |
|------------|----------|--------------------|------------------------------|
| KMS30S-150 | mechanic | 18 / 39.6          | 0.5 - 2.0 / 1,100 - 4,400    |
| KMS30S-180 | mechanic | 18 / 39.6          | 0.5 - 2.0 / 1,100 - 4,400    |
| KMS40S     | mechanic | 50 / 121           | 2.0 - 6.0 / 4,400 - 13,200   |
| KMS45S     | mechanic | 90 / 198           | 6.0 - 11.0 / 13,200 - 24,200 |
| KMS50S     | mechanic | 88 / 194           | 6.0 - 11.0 / 13,200 - 24,200 |

Package consists of: mechanic quick coupler, socket

## Hydraulic Quick Couplers KHS-S

| Type       | Locking   | Weight<br>(kg/lbs) | Operating weight<br>(t/lbs)  |
|------------|-----------|--------------------|------------------------------|
| KHS30S-150 | hydraulic | 15 / 33            | 0.5 - 2.0 / 1,100 - 4,400    |
| KHS30S-180 | hydraulic | 15 / 33            | 0.5 - 2.0 / 1,100 - 4,400    |
| KHS40S     | hydraulic | 50 / 121           | 2.0 - 6.0 / 4,400 - 13,200   |
| KHS45S     | hydraulic | 90 / 198           | 6.0 - 11.0 / 13,200 - 24,200 |
| KHS50S     | hydraulic | 88 / 194           | 6.0 - 11.0 / 13,200 - 24,200 |

Package consists of: hydraulic quick coupler

## Installation sets for hydraulic Quick Couplers KHS-S

| Type                                     | Description                                |
|--|--|
| KHS03L HD-KHS08L installation set safety | incl. KHS Control unit                     |
| KHS03L HD-KHS08L installation set basic  | incl. unlockable flip switch (hold to run) |

## Accessories

| Type                    | Description  |
|-------------------------|--|
| KM 685 06 KSW01 hook    | load hook (1t / 2,200lbs load capacity) for KMS/KHS30S                 |
| KM 685 06 KSW03 hook 3t | load hook (3t / 6,600lbs load capacity) for KMS/KHS40S                 |
| KM 685 06 KSW08 hook    | load hook (5t / 11,000lbs load capacity) for KMS/KHS45S and KMS/KHS50S |

## Requirements of carrier machine for KHS-S

|                   | KHS30S & KHS40S   | KHS45S & KHS50S |
|-------------------|---|-----------------|
| Hydraulic system: | one double-acting hydraulic circuit                       |                 |
| Note:             | excavator needs to be equipped with quick coupler control |                 |

The S-Lock System was designed to be fully compatible with the internationally adopted S-Standard adapters. In addition to a specially engineered, centrally located locking mechanism, the S-Lock coupler features a second locking mechanism at the front pin, providing a twin lock system for maximum safety.

- ▷ KMS-S with mechanic locking system.
- ▷ KHS-S with hydraulic locking system.
- ▷ Safe mechanic or hydraulic locking available.
- ▷ Use of robust and durable cast housings.
- ▷ Fully compatible with the original quick coupler systems or standards.



KHS70S  
here with hook

### Mechanic Quick Couplers KMS-S

| Type   | Locking  | Weight<br>(kg/lbs) | Operating weight<br>(t/lbs) |
|--------|----------|--------------------|-----------------------------|
| KMS60S | mechanic | 181 / 398          | 10 - 18 / 22,000 - 39,600   |
| KMS70S | mechanic | 298 / 656          | 18 - 30 / 39,600 - 66,000   |

Package consists of: mechanic quick coupler, socket

### Hydraulic Quick Couplers KHS-S

| Type   | Locking   | Weight<br>(kg/lbs) | Operating weight<br>(t/lbs) |
|--------|-----------|--------------------|-----------------------------|
| KHS60S | hydraulic | 183 / 403          | 10 - 18 / 22,000 - 39,600   |
| KHS70S | hydraulic | 300 / 660          | 18 - 30 / 39,600 - 66,000   |

Package consists of: hydraulic quick coupler

### Installation sets for hydraulic Quick Couplers KHS-S

| Type                                     | Description                  |
|--|------------------------------|
| KHS03L HD-KHS08L installation set safety | incl. KHS Control unit       |
| KHS03L HD-KHS08L installation set basic  | incl. unlockable flip switch |

### Accessories

| Type                 | Description  |
|----------------------|--|
| KM 685 06 KSW10 hook | load hook (8t / 17,600lbs load capacity) for KMS/KHS60S  |
| KM 685 06 KSW21 hook | load hook (10t / 22,000lbs load capacity) for KMS/KHS70S |

### Requirements of carrier machine for KHS-S

|                     |   |
|---------------------|---|
| Operating pressure: | 160 - 300 bar / 2,320 - 4,350 psi (to be set at excavator)                        |
| Hydraulic system:   | one double-acting hydraulic circuit with safety switch (permanent pressure close) |
| Note:               | excavator needs to be equipped with quick coupler control.                        |

# Accessories for Quick Couplers, Tilt Couplers and Rotary Couplers

unlockable flip switch (hold to run)



KHS Control

## Installations sets for hydraulic quick couplers and tilt couplers

| Type                                     | Description                                |
|--|--|
| KHS01L-KHS03L installation set safety    | incl. KHS Control unit                     |
| KHS01L-KHS03L installation set basic     | incl. unlockable flip switch (hold to run) |
| KHS03L HD-KHS08L installation set safety | incl. KHS Control unit                     |
| KHS03L HD-KHS08L installation set basic  | incl. unlockable flip switch (hold to run) |

## Non-return valve sets for hydraulic tilt couplers TC

| Type              | Description                            |
|-------------------|--|
| TC02-TC03-180 NRV | non-return valve set for TC02 and TC03 |
| TC045-180 NRV     | non-return valve set for TC045         |
| TC07-180 NRV      | non-return valve set for TC07          |
| TC10-180 NRV      | non-return valve set for TC10          |
| TC14-140 NRV      | non-return valve set for TC14          |

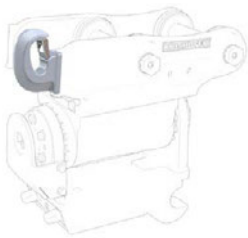

## Load hook for quick couplers and tilt couplers

| Type                    | Description  |
|-------------------------|--|
| KM 685 06 KSW01 hook    | load hook for system L-Lock (1t / 2,200lbs load capacity)  |
| KM 685 06 KSW03 hook 2t | load hook for system L-Lock (2t / 4,400lbs load capacity)  |
| KM 685 06 KSW03 hook 3t | load hook for system L-Lock (3t / 6,600lbs load capacity)  |
| KM 685 06 KSW08 hook    | load hook for system L-Lock (5t / 11,000lbs load capacity) |

KMS01L socket & KMS03L socket



KMS08L socket

## Sockets for mechanic quick couplers and tilt couplers

| Type          | Description  |
|---------------|--|
| KMS01L socket | socket for mechanical System L-Lock (KMS01)            |
| KMS03L socket | socket for mechanical System L-Lock (KMS03)            |
| KMS08L socket | socket for mechanical System L-Lock (KMS08) and S-Lock |

## Quick coupling adapters for System L-Lock

| Type           | Description   |
|----------------|---|
| KSW01 rigid    | bolt-on adapter   |
| KSW01 cardanic | adapter for cardanic suspension incl. suspension, w/o pendulum damper |
| KSW03 rigid    | bolt-on adapter   |
| KSW03 cardanic | adapter for cardanic suspension incl. suspension, w/o pendulum damper |
| KSW08 rigid    | bolt-on adapter   |
| KSW08 cardanic | adapter for cardanic suspension incl. suspension, w/o pendulum damper |



# Accessories for Quick Couplers, Tilt Couplers & Rotary Couplers

unlockable flip switch (hold to run)



KHS Control

## Installations sets for hydraulic quick couplers and tilt couplers

| Type                                     | Description                                |
|--|--|
| KHS03L HD-KHS08L installation set safety | incl. KHS Control unit                     |
| KHS03L HD-KHS08L installation set basic  | incl. unlockable flip switch (hold to run) |
| KHS10L installation set safety           | incl. KHS Control unit                     |
| KHS10L installation set basic            | incl. unlockable flip switch (hold to run) |
| KHS21L installation set safety           | incl. KHS Control unit                     |
| KHS21L installation set basic            | incl. unlockable flip switch (hold to run) |
| KHS25L installation set safety           | incl. KHS Control unit                     |
| KHS25L installation set basic            | incl. unlockable flip switch (hold to run) |



## Locking sensor for hydraulic quick couplers and tilt couplers with System L-Lock

| Type                              | Description  |
|-----------------------------------|--|
| KHS-L-Sensor                      | 2 sensors support the secure locking, only in combination with KHS10-25L installation set sensor |
| KHS10-25L installation set sensor | KHS-L installation set safety including cable loom for quick coupler sensors                     |

## Non-return valve sets for hydraulic tilt couplers TC



| Type         | Description                       |
|--------------|-----------------------------------|
| TC14-140 NRV | non-return valve set for TC14-140 |
| TC19-140 NRV | non-return valve set for TC19-140 |
| TC23-140 NRV | non-return valve set for TC23-140 |

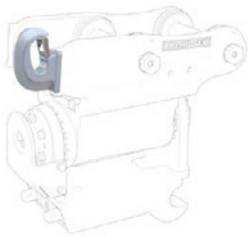

## Load hook for quick couplers and tilt couplers

| Type                 | Description                             |
|----------------------|---|
| KM 685 06 KSW10 hook | load hook (8t/17,600lbs load capacity)  |
| KM 685 06 KSW21 hook | load hook (10t/22,000lbs load capacity) |
| KM 685 06 KSW25 hook | load hook (18t/39,600lbs load capacity) |



## Sockets for mechanic quick couplers and tilt couplers

| Type             | Description   |
|------------------|---|
| KMS10L socket    | socket for mechanical System L-Lock (KMS10L)        |
| KMS21/25L socket | socket for mechanical System L-Lock (KMS21L/KMS25L) |
| KMS08L socket    | socket for mechanical System S-Lock                 |



## Quick coupling adapters for System L-Lock

| Type              | Description   |
|-------------------|---|
| KSW10 rigid       | bolt-on adapter   |
| KSW10 cardanic    | adapter for cardanic suspension incl. suspension, w/o pendulum damper |
| KSW21/25 rigid    | bolt-on adapter   |
| KSW21/25 cardanic | adapter for cardanic suspension incl. suspension, w/o pendulum damper |